



**St George
College**

International Students
Handbook



A Co-educational College

Offering education and care for
students from ELC to Year 12

sgc.sa.edu.au



Welcome to St George College

Message from the Principal

On behalf of everyone at St George College, a warm welcome. We are an inclusive community with a rich blend of cultures and backgrounds. We are blessed to have international students to enrich our College in many ways. Their global outlook reminds us that we are all citizens of the world.

Student learning and student success is always at the centre of our school culture. We are committed to ensuring our students are “World Ready” through a focus on developing their academic and personal skills.

The sense of community at St George College is important and highly valued. The partnership between the College, parents, families and the wider community is vital in fully developing our students and in providing a well-resourced and supportive learning environment.

A St George College education will offer your child:

- An education where each individual child is encouraged to be the best they can be.
- Inspirational, differentiated teaching and learning experiences that inspire excellence.
- Enrichment programs; early intervention initiatives; and learning support programs, that strengthen foundations in literacy and numeracy
- Support programs designed specifically for our international students
- Regular feedback to students, parents, and caregivers, regarding strategies for continuous improvement.
- Quality teachers with a genuine love for children
- Language classes.
- Co-curricular programs to allow students to follow their sporting or cultural interests and passions
- Regular assemblies where we celebrate the successes of our children

“Children are the greatest blessing in life for any couple and indeed are a gift from God. The greatest gift parents can pass onto their children is to lay the foundations for them to know and accept Jesus Christ as their Lord and Saviour. Orthodoxy is a way of life.”

Visit us to gain a deeper understanding of what a St George College education looks like and how we can work together to support the academic and personal development of your child.

Please contact me for a personal tour or for more information.

Principal

Peter Karamoshos



Contents:

Important Information.....	5
School Information.....	7
Why Adelaide.....	8
Why St George College.....	9
School Fees.....	10
Application Process	12
Code of Conduct / Behaviour Policy.....	14
EDUCATION IN AUSTRALIA (ESOS FRAMEWORK)	16
Permanent Accommodation.....	18
Happy Homestay Adelaide.....	19
Overseas Student Health Cover (OSHC)	20
First Day of School.....	21
Student Administration Information.....	22
Quick Key Guide.....	23
Campus and Facilities Maps.....	25



Mr Peter Karamoshos
Principal



Mr Paul Apostolou
Assistant Principal / Head of Junior Campus



Mr Ben Hall
Head of House (International Students)



Important Information and Emergency Contacts

St George College Contact Details:

Ph: +6188159 8100
www.sgc.sa.edu.au
registrar@sgc.sa.edu.au
24 Hour Emergency: Peter Karamoshos, Principal 0400 664 519

St George College International Student & EAL/D Coordinator

Mr Ben Hall
Ph: +61 8 8159 8100
bhall@sgc.sa.edu.au

Emergency Telephone Numbers:

Police, Fire, Ambulance – 000

Department of Home Affairs (DHA)

70 Franklin Street
ADELAIDE 5000
13 18 81

Medical Centres:

International Student Friendly Gawler Place Medical Practice

Level 1/49 Gawler Place
Adelaide SA 5000
(08) 8212 7175

www.adelaideunicare.com.au

East Adelaide Medical Centre

50 Hutt Street
Adelaide SA 5000
(08) 8210 9444

Parade Medical Centre

291 The Parade
Beulah Park
(08) 8364 1133



Transport:

Adelaide Metro Info Centre

Adelaide Railway Station (near the barrier gates to the trains)

North Terrace, Adelaide

Phone: 1300 311 108

Open 7am–8pm every day

Call the Interpreting and Translating Centre (ITC) on [1800 280 203](tel:1800280203) and say the language you need in English (e.g. say 'French' not 'Français'). [Visit the ITC website for more information](#), including their business hours.

Public facilities:

Location of Automatic Teller Machines (ATMs)

149 Henley Beach Road, Mile End

190 Henley Beach Road, Torrensville

Or visit: <http://www.rediatm.com.au/atm-locator>

Location of Public Telephones

34 Parker Street, Mile End

66 George Street, Thebarton

Or visit: <http://envinsaonline.mapinfo.com.au/ppol/>

Post Office

159 Henley Beach Road
Mile End SA 5031

141 King William Street
Adelaide SA 5000

Ph: 13 13 18

School Information

Please refer to the St George College website www.sgc.sa.edu.au/curriculum for the subjects and co-curricular activities offered at the College.

Curriculum Handbooks can be found at www.sgc.sa.edu.au/resources

St George College operates over four terms (2 semesters):

Semester 1

Term 1	January to April	(11 weeks)
Term 2	April to July	(9 weeks)

Semester 2

Term 3	July to September	(10 weeks)
Term 4	October to December	(9 weeks)

St George College is committed to the development of every student in a social, emotional, spiritual, and academic sense.

Learning is optimised when students feel safe, feel supported and feel they belong. Learning is optimized when students feel safe and belong to a supportive community.

Pastoral Care

- **Sense of Identity and belonging**
 - Sense of Identity and belonging is grown best by developing college pride, involvement and participation. It develops confidence in each student which builds self-esteem. Each student belongs to one of four Houses: Athens, Olympia, Pella, or Sparta. The House focuses on allowing all students to be involved in inter-house sport activities, which run on Tuesdays and Thursdays.
- **Heads of House**
 - Follow up on student's academic and social needs and offer behavioral support when needed. Create an atmosphere where students can talk about what is on their minds. Make the students feel safe.
- **Faith**
 - Regular Chapel Service for all Year 11 and 12 students. Weekly religion lessons for all other year levels. Gives our students an opportunity to learn more about the Christian Orthodox Faith, to explore their own faith and to reflect on life in general.
- **Weekly Assemblies**
 - Weekly Assemblies celebrate our values, community and culture. Assemblies are organised for special events such as subject semester academic awards, co-curricular, presentations, Anzac Day, Harmony Day, Greek Independence Day and Remembrance Day, just to name a few. Guest speakers and old scholars are regularly invited to share their life stories to inspire students. Our student leaders run these assemblies.



Why Adelaide?

Adelaide is a multicultural, sophisticated city of over 1.3 million people. Adelaide is secure, clean, well-planned, and offers a number of events, and professional opportunities. Adelaide has a diverse range of services, including sports, food, and academia. Access to the city and other regions is simple and dependable. St George College is an ideal location for international students, situated just 3 kilometres from the CBD.

Adelaide is free of the noise and chaos that other cities have, and Adelaide is home to four renowned universities. It is also the most affordable choice for international students and is regarded as one of the most livable cities in the country.

Most significantly, Adelaide is known as an education city that meets the demands of serious students. From Nobel Laureates and Rhodes Scholars to world-renowned academics, the city has generated an amazing array of great achievers.

The weather in South Australia

These are the average daily temperatures for Adelaide:

- Average daily winter temperatures (June - August), Adelaide - Max 15.9°C, Min 8°C.
- Average daily spring temperatures (September - November), Adelaide - Max 21.7°C, Min 11.6°C.
- Average daily summer temperatures (December - February), Adelaide - Max 28.3°C, Min 16.5°C, but daily temperatures can get as high as 45°C.
- Average daily autumn temperatures (March - May), Adelaide - Max 22.4°C, Min 12.5°C
- Time Zones

South Australia operates on Australian Central Standard Time (ACST) which is 30 minutes behind Australian Eastern Standard Time



Why St George College?

At St George College, our students are supported through every stage of their academic, personal and spiritual development. We support your decision to give the greatest education to your children. We have continually maintained a superb reputation as a top choice for both local and international families.

International students at St George College are invited to become part of a lively student body, while learning about and understanding Australia, its culture, and people. We work closely with our international students to ensure their transition and time with us is as enjoyable and rewarding as possible.

We provide extensive Wellbeing programs that are taught as well as demonstrated while, our broad curriculum embraces “learn by doing” projects and entrepreneurship. Individual interests and passions can be pursued through our co-curricular and extra-curricular choices, while simultaneously building confidence, compassion and resilience. These are the skills our students need to be “World Ready” supported by the College’s values of Faith, Family and Forever Excelling.





International Student Fees

This schedule must be read in conjunction with the [International Student Fee Policy](#) (and other St George College Policies) which are available by visiting our website www.sgc.sa.edu.au

Tuition Fees

Junior School	Annual	Per Semester
Reception	\$17,500.00	\$8,750.00
Year 1	\$18,000.00	\$9,000.00
Year 2	\$18,500.00	\$9,250.00
Year 3	\$19,000.00	\$9,500.00
Year 4	\$19,500.00	\$9,750.00
Middle School	Annual	Per Semester
Year 5	\$20,000.00	\$10,000.00
Year 6	\$20,000.00	\$10,000.00
Year 7	\$20,000.00	\$10,000.00
Year 8	\$21,000.00	\$10,500.00
Senior School	Annual	Per Semester
Year 9	\$21,000.00	\$10,500.00
Year 10	\$21,000.00	\$10,500.00
Year 11	\$22,000.00	\$11,000.00
Year 12	\$22,000.00	\$11,000.00

Fee Schedule Review & Approval: The College Board reviews the level and structure of fees within the Fee Schedule annually.

International Student Enrolments

St George College accepts international students from Years R to 12, subject to availability. Enrolments may be offered at the exclusive discretion of the College following an assessment process.

Confirmation of Enrolment

In order to secure a Confirmation-of-Enrolment (COE) at St George College, a payment of the first year's Annual Tuition Fee is required.

Tuition Fee Payment Due Dates

It is the responsibility of each family to ensure that fee payments are made in accordance with the College's Fee Policy and Terms & Conditions of Enrolment. Following the initial annual Tuition Fee payment to secure the COE, Tuition Fees are payable in advance of each Semester no later than:

- **Semester 1 (School Terms 1 & 2): No later than the end of January**
- **Semester 2 (School Terms 3 & 4): No later than the end of July**

Failure to pay Tuition Fees by the Due Dates may result in cancellation of the COE in accordance with the College's Deferment, Suspension and Cancellation Policy.

Short Term Enrolments

If a student is offered enrolment for less than one (1) year, Tuition Fees will be pro-rated based upon the dates of attendance, plus an administration fee of \$1,000.00. No student from Years 10, 11 and 12 should be enrolled for less than one (1) year of study.



Uniform and Textbooks

Uniforms and textbooks are Non-Tuition Fees and are purchased at an additional cost.

Payments & Merchant Fees

All payments must be made in Australian Dollars (AUD), net of any transactional costs incurred. The College's preferred method of payment for Tuition Fees is Electronic Funds Transfer. Payments may also be made by Bpay, Eftpos, Debit MasterCard, MasterCard Credit, Visa Debit, Visa Credit. A surcharge of 0.78% will apply to all Tuition Fee payments made by Australian debit and credit cards. This surcharge equals the merchant fee transaction costs incurred by the College. International credit and debit cards may be accepted at the College's exclusive discretion and may attract higher surcharges based upon the costs incurred by the College. American Express and Diners Card are not accepted.

Homestay Accommodation

The College requires any international student not residing with their parent to be hosted with Happy Homestay Adelaide for the duration of their studies, which carries a minimum cost of \$325.00 per week and other incidental costs as outlined at <https://happyhomestay.com.au>

Notice of Withdrawal & Refunds

It is mandatory that students withdrawing from the College advise the Registrar registrar@sgc.sa.edu.au in the first instance. Any outstanding fees are payable immediately upon provision of notice of withdrawal. The College's International Student Refund Policy ("Refund Policy") outlines refunds applicable to Course Fees paid to the College in the event of withdrawal, visa refusal or student default or provider default.

Please refer all family account enquiries to the College's Finance Department on 8159 8100 or familyaccounts@sgc.sa.edu.au

Please refer to our website for further details on the College's International Student program, including the full terms & conditions of enrolment: <https://www.sgc.sa.edu.au/international-students/>



Application Process

St George College is a Commonwealth Registered Institute for Overseas Students to enrol Full Fee Paying students. **CRICOS Provider No 02799F**

St George College is registered to provide the following courses:

Provider Code	Course Code	Course Name
02799F	096720G	Primary Years Reception to 6
02799F	096721F	Junior Secondary Years 7 to 10
02799F	096722E	Senior Secondary Years 11 to 12

International students interested in enrolling at St George College may request information from the College Registrar or explore our website at www.sgc.sa.edu.au. Information provided in response to requests will be given without charge.

Applications can be made by submitting a completed International Student Application for Enrolment form, together with the required documentation (please see below).

Applications are assessed with consideration to the following:

- Availability at the appropriate year level
- College resources
- Students academic records and English Language proficiency for the proposed course of study (students may be required to undertake Intensive English language study prior to their entry to mainstream study)
- Students must reside in Australia with either:
 - One or both parent/s
 - A homestay provider organised through the Australian Homestay Network (AHN)

It is essential that the College be kept informed of any changes to the information provided in the application. It is the responsibility of the student, parent/guardian, or agent to provide the school with advice of changes to address and contact details. Failure to do so may mean the applicant is not issued with an offer of enrolment.

St George College will assess the application, including evaluation of reports and English Language proficiency. The Principal will make the final decision on acceptance of International Students into the College.

Applicants who are offered a place will be required to complete a contractual Acceptance of Enrolment document and agree to be comply by the College's policies and conditions of enrolment.

PLEASE NOTE: Submitting an International Student Application for Enrolment form is NOT an Offer of Enrolment or a Notice of Acceptance.

An Offer of Enrolment letter will be issued, in writing, by the Principal / Registrar.

Acceptance of Enrolment is made by signing and returning the Declaration on the Offer of Enrolment letter, and the Acceptance of Enrolment Agreement.

Upon receipt of these signed documents, an invoice for tuition fees will be issued. Once the invoice has been paid, a Confirmation of Enrolment (CoE) and Certificate of Appropriate Accommodation and Welfare (CAAW) will be issued for visa application.

Please note that money or payment of fees should not be made until an Acceptance Agreement has been submitted and an invoice issued.



STEP 1: Student enquiry and application

Visit www.sgc.sa.edu.au for information regarding the College. Familiarise yourself with College policies.

Complete the International Student Application for Enrolment form.

The following documentation must be submitted with the application:

- Certified copy of Passport
- Certified school report (translated in English)
- Certified copies of English Language proficiency

Make sure you have read the criteria and conditions on the Application form

Return the completed application, and required documentation to:

Registrar

St George College

PO Box 29, TORRENSVILLE PLAZA, SA, 5031, AUSTRALIA

Or Email: registrar@sgc.sa.edu.au

STEP 2: Offer of Enrolment is Issued

Once the Principal has approved the application, and Offer of Enrolment letter will be sent

STEP 3: Student Acceptance

The signed Declaration page and completed Acceptance Agreement is returned to the Registrar.

An invoice for the first year's tuition fees is issued.

Fees are paid

STEP 4: CoE and CAAW are Issued

Once the invoice is paid, the Registrar will issue the CoE and CAAW.

STEP 5: Student finalises VISA conditions with DHA

Student / Agent provides St George College with a copy of the Visa Grant Notice

STEP 6: Student finalises Travel and Accommodation arrangements

Student / Agent notifies St George College of the travel and accommodation arrangements.

St George College will assist with arranging homestay through Australian Homestay Network (AHN) if required.

Please contact registrar@sgc.sa.edu.au for assistance.

STEP 7: Student arranges Overseas Student Health Cover (OSHC)

You must have adequate health insurance while in Australia. This is done by obtaining Overseas Student Health Cover (OSHC) which provides medical and hospital insurance in Australia. You must not arrive in Australia before your health insurance starts. If you are in Australia and do not have adequate health insurance, you are in breach of your visa conditions.

Students are responsible for obtaining OSHC.

STEP 8: Student arrives in Australia

Student will be greeted at the Airport, if requested.

Student can be transported to their Homestay provider by a chauffeured service if required.

STEP 9: College Orientation

Students will be sent a letter outlining the Orientation arrangements

STEP 10: Classes Begin



Code of Conduct / Behaviour Policy

Philosophy

When students enter the College, they subscribe to the Code of Conduct acceptable to the College Community which is based on our philosophy.

We believe that the St George College Code of Conduct should result in the realisation of the following:

- Students develop responsibility to self, to others and to the environment
- Students learn to behave in a manner that promotes safety, learning, productive relationships and College standards
- Students treat people and property with respect
- Students develop a way of life that is based on the beliefs of the Orthodox faith.

This translates into the following **rights and responsibilities**:

- Students have a right to work in a safe and secure environment where, without intimidation, they are able to fully develop their talents, interests and ambitions
- Parents have a right to expect that their children will be educated in a secure environment
- Teachers have a right to expect that they will be able to teach in an orderly and cooperative environment
- Everyone has the right to be free from all forms of harassment; racial, sexual, verbal and emotional.

Consequently

- Students have the responsibility to behave in a responsible, safe and respectful manner, to take initiative and be focussed in their learning
- Parents have a responsibility to act as positive role models and support the College in its efforts to maintain a positive teaching and learning environment
- The Principal and Staff have a responsibility to engender Christian love and respect and to implement the Code of Conduct reasonably, consistently and fairly.

Conduct at the College

- Students are to enter and move around and between buildings in a quiet and orderly manner
- Students are to arrive for school and lessons punctually and well organised
- Students are to be courteous in their dealings with others; they are to respectfully greet teachers and other members of the College community
- Students are expected to stand when they are greeted by an adult and when an adult enters the room
- Students are expected to greet the Greek Orthodox Reverend Fathers in a respectful and appropriate manner, which includes kissing their hand to receive their blessing
- Students are to respect the property of others; great care is to be taken of all College buildings, furniture and equipment

- Students are to comply promptly with directions of ALL staff as well as SRC and Prefects who assist in maintaining proper standards of behaviour and discipline
- Students are not to run in corridors or on stairs
- Students are not to eat in corridors or on stairs
- Students are expected to stand aside politely and allow adults to enter first when entering any room
- Ball games are not to be played near windows or anywhere indoors
- Chewing gum is not permitted to be brought to or used at the College
- Smoking and alcohol are not permitted when wearing the College uniform or during any College activity
- Illegal substances and material are a police matter
- Students' language, both verbal and non-verbal, must be always beyond reproach

Conduct Away from the College

- On public transport, students are to keep their voices down. Students are to remain seated in one place but are to offer their seats to adults. Jostling and leaning out of windows or doors is unacceptable
- On leaving the College, students are to go straight home unless accompanied by parents or there is a specific purpose. Loitering, especially at bus stops, railway stations or the City is not permitted
- Notes signed by parents, are required before students may leave the College grounds during the school day, except when standing arrangements have been made with parents
- Students whilst on camps and excursions are to comply with teachers' instructions and adhere to rules and guidelines for camps as explained by teachers prior to excursions and camps.





EDUCATION IN AUSTRALIA (ESOS FRAMEWORK)

The Australian Government, as does St George College, wants International Students in Australia to have a safe, enjoyable and rewarding place to study.

Australia's laws promote quality education and consumer protection for International Students. These laws are known as the ESOS framework and they include the *Education Services for Overseas (ESOS) Act 2000* and the National Code 2007.

Protection for International Students

As an International Student on a student visa, you must study with an education provider and in a course that can be found on the Commonwealth Register of Institutions and Courses for International Students (CRICOS) at www.cricos.education.gov.au

CRICOS registration guarantees that the course and the education provider with whom you study meet the high standards necessary for International Students. Please check carefully that the details of your course – including its location – match the information on CRICOS.

St George College maintains current Tuition Protection Scheme at all times which ensures that your tuition fees are insured and safe.

Your Rights

The ESOS framework protects your rights, including your right to:

- Receive, before enrolling, current and accurate information about the courses, fees, modes of study and other information from your provider and your provider's agent.
- Sign a written agreement with your provider before or as you pay fees, setting out the services to be provided, fees payable and information about refunds of tuition fees. You should keep a copy of your written agreement.
- Get the education you paid for. The ESOS framework includes consumer protection that will allow you to receive a refund or to be placed in another course if your provider is unable to complete your course.
- The Tuition Protection Service (TPS) is a placement and refund service for international students, which is activated in the event that your provider is unable to teach your course. Visit the TPS website for more information, at www.tps.gov.au
- The ESOS framework sets out the standards Australian education providers offering education services to International Students must obey. These standards cover a range of information you have a right to know and services that must be offered, including:
 - Orientation and access to support services to help you study and adjust to life in Australia
 - Who the contact officer is for International Students
 - If you can apply for course credit
 - when your enrolment can be deferred, suspended or cancelled
 - What your provider's requirements are for satisfactory progress in the courses you study and what support is available if you are not progressing well
 - If attendance will be monitored for your course, and
 - A complaints and appeals process.



- One of the standards does not allow another provider to enrol a student who wants to transfer to another course but who has not completed six months of the principal course of study in Australia. If you want to transfer before you have completed six months of your principal course you need your provider's permission unless there are special circumstances such as:
- You have completed more than 6 months of your principal course;
- You are a government sponsored student, and your sponsor supports a transfer, or
- Your current education provider or course has ceased to be registered or a sanction has been imposed that prevents your provider from continuing to deliver your principal course.
- If you are under 18, to ensure your safety, you will be granted a visa only if there are arrangements in place for your accommodation, support and welfare.

Your responsibilities

As an international student on a student visa, you have responsibilities to:

- Satisfy your student visa conditions
- Maintain your International Student Health Cover (OSHC) for the period of your stay
- Meet the terms of the written agreement with your education provider
- Inform us of any changes to your contact details immediately and provide us with confirmation of your contact details at least every 6 months (please refer Appendix 2 Change of Details Form)
- Maintain satisfactory course progress
- If attendance is recorded for your course, follow your provider's attendance policy, and
- If you are under 18, maintain your approved accommodation, support and general welfare arrangements.

More information on studying in Australia, go to www.aei.gov.au or ESOS Helpline +61 2 6240 5069

For Visa matters go to www.homeaffairs.gov.au or telephone 131881 in Australia, or contact a DHA office in your country.

Privacy

Information will be collected about you during your enrolment, in order to meet our obligations under the ESOS Act and the National Code 2007. The authority to collect this information is contained in the Education Services for Overseas Student Act 2000, the Education Services for Overseas Students Regulations 2001 and the National Code of Practice for Registration Authorities and Providers of Education and Training to Overseas students 2007.

Information collected during your time at St George College can be disclosed without your consent where authorised or required by law. Information may be shared between St George College and the Australian Government and designated authorities and, if relevant, the Tuition Protection Service. This information includes personal and contact details, course enrolment details and changes, and the circumstance of any suspected breach by the student of a student visa condition.

Please visit the College website at www.sgc.sa.edu.au for the St George College Privacy Policy.

Permanent Accommodation

Choosing Where to Live

Most students want to live within walking distance of the campus, but this is not always possible and is usually determined by availability and cost. Often it is more convenient and more cost-effective to live further from the campus but closer to shops and public transport.

Students enrolled at St George College who do not live with a parent must reside with a Homestay provider as arranged through the Happy Homestay Adelaide (HHA)



Happy Homestay Adelaide (HHA)



HAPPY HOMESTAY ADELAIDE

International students who do not live with a parent or blood relation in Adelaide live in Homestay. Homestay is a wonderful opportunity for cultural exchange between the student and an Australian family. St George College has partnered with the Happy Homestay Adelaide (HHA) (<https://happyhomestay.com.au/>) to give students the opportunity to be hosted by a specially trained AHN Homestay host, for a safe and happy introduction to living and studying in Australia.

Homestay hosts assist students to settle into their new life in Adelaide and provide useful tips and information needed for a rewarding and unforgettable experience. Most importantly students in Homestay are treated as a participating family member. This helps improve the student's English and lessen homesickness.

Students are supplied with meals, their own bedroom with study facilities, access to bathroom and laundry facilities and transport to and from school. Personal belongings are also covered by insurance under the HHA-SA Insurance Policy.

Happy Homestay Adelaide Fees

Student Homestay Pricing – Under 18 years:	
Homestay Placement	\$290
Homestay Fee (weekly) – Single	\$335
Homestay Fee (weekly) – Share	\$285
Internet (weekly)	\$10
Holding Fee (weekly)	\$150

*Current Fee's at time of printing. Fees and charges may change.

Conditions for Students

- Fees are quoted in Australian dollars (GST inclusive where applicable) per student.
- Free of charge for Airport Transfer for the first arrival student.
- Once HHA begins to work on your placement, the placement fee will be charged and is non-refundable.
- Submit the Student Application 2 weeks before your arrival so suitable homestay can be arranged.
- If you wish to be moved to another homestay, HHA and your current host family must be informed 2 weeks in advance. An additional Homestay Placement fee will be charged for the new Homestay placement.
- Inform HHA 2 weeks in advance if you wish to end your stay with HHA. Any unused homestay fee will be refund-ed.
- Holding Fee: If you plan to go away for a holiday, you must notify HHA and your host family 2 weeks prior to the departure date. Holding fee ensures that your host family keeps your room and secures your possessions during your holiday.
- Security bond, \$800 is payable in your first payment. The bond is fully refundable at the end of the Homestay with HHA if there are no claims by the host family or third parties.
- All homestay payments are payable to Happy Homestay Adelaide in advance.
- Homestay fees and rates are subject to change without notice

Notes: Guardian arrangement service is available, please contact HHA for further information.



Overseas Student Health Cover (OSHC)

Overseas student health cover (OSHC) is insurance that provides cover for the costs of medical and hospital care which international students may need while in Australia and is mandatory for international student visa holders. OSHC will also cover the cost of emergency ambulance transport and most prescription drugs.

How do I get OSHC?

St George College do not arrange OSHC for students. Your Educational Agent will be able to assist you with obtaining OSHC.

Only Australian health funds that have signed an agreement with the Australian Government can provide OSHC. Most Australian education institutions have a preferred OSHC provider. Depending on the institution you will be attending you will be required to join one of these four registered health funds. You may choose to change your health fund at any time but will need to abide by the conditions of change of the health fund provider you are leaving.

OSHC Providers

Medibank Private: www.medibank.com.au

OSHC World care: www.oshcworldcare.com.au

BUPA OSHC: www.overseasstudenthealth.com

Australian Health Management: www.ahm.com.au

Students may also take out additional cover in the form of Extra OSHC and students who could not previously access OSHC may now be able to access Optional OSHC. Some students may be exempt from enrolling in the OSHC such as students from countries whose Governments may have Reciprocal Health Agreements for students in Australia. Note: only some reciprocal health agreements cover students in Australia, some will only cover visitors. You should determine if you are eligible before you apply for your visa to come to Australia.

Further information on OSHC can be found at: <http://www.health.gov.au/internet/main/publishing.nsf/Content/health-privatehealth-consumers-ovc.htm>

If you come to Australia on a visa other than a student visa and undertake a **short course of study of three months duration or less** you will not be eligible for OSHC. It is wise to purchase travel or private medical insurance in this case.

What am I covered for?

OSHC provides a safety net for medical expenses for international students, similar to that provided to Australians through Medicare. Additionally, OSHC includes access to some private hospitals and day surgeries, ambulance cover and benefits for pharmaceuticals.

How do I use my OSHC card?

If you need to visit a doctor or medical centre, show your card at the end of the visit. You will be charged the doctor's fee and the government fee component of that **may** be processed by the medical centre. If the medical centre is not able to process the government fee, pay the total amount, keep the receipt and you can claim the government fee back from your OSHC provider.



First Day of School

Arrive early

St George College will provide an International Student Orientation before the commencement of. It is a requirement of the ESOS (Education Services for Overseas Students) Act 2001. Staff who run the orientation work hard to ensure that you as a student will be well equipped to achieve the best possible success in your studies. If you read through the pre-departure, arrival, and orientation pack which is provided for you, you will see that there is a lot of information for you to understand and consider as you move through your studies. Although the information will outline what you need to know, it is impossible to understand and recall everything. Once you are concentrating on your studies, you will feel less stressed if you are already comfortable with the institution, its staff and its services.

Arriving early to attend orientation gives you the chance to.

Meet and talk to the most important people you will need to know at St George College:

- Principal
- Head of International Students
- Director of Daily Operations
- Home Group teacher
- Front Office staff
- Registrar
- Meet Other international students

Enrol early which will help you to get your student ID card early. You will need your student card to open bank accounts, borrow books from the library, and more.

- Meet and get advice from your Head of International Students
- Find your way around the campus
- Library
- Computer rooms and facilities
- Recreation and eating areas
- Classrooms
- Find your way around the public transport/ City/ to and from your accommodation.
- Feel as though you already know some of the things local students know before you get to meet them at orientation activities later.

What to Do First

Report to the Front Office where the Registrar will meet you. You will also meet the Principal, Mr Peter Karamoshos, Assistant Principal, Miss Paul Apostolou and Mr Ben Hall, Head of House (International Students).



Student Administration Information

Paying Fees

Invoices for tuition fees are issued each semester. The invoice includes instructions regarding how payment can be made. Please contact familyaccounts@sgc.sa.edu.au should you have any queries or concerns regarding payment of fees.

Textbooks

Students are responsible for payment of all the required textbooks. Textbooks can be ordered once you have selected your subjects. St George College staff are available to assist you with placing an order. Books are ordered online through Campion Education www.campion.com.au

Subject Selection:

Subject selection forms will be sent to you prior to commencement of your studies, along with the Curriculum booklet for your Year Level, which outlines the subjects available. Please take the time to familiarise yourself with the subjects offered so you can make an informed choice according to your subject interests. St George College staff will be available at Orientation to assist you with your subject selection.

Timetables:

Once your subject choices are finalised, you will be given your class timetable and shown the location of your classes.

Term Calendar of Events:

The Term Calendar lists all the events and special dates for the term, including excursions, examination periods, religious events etc. You will be given a copy of the Term Calendar at your Orientation visit. The Term Calendar is updated and given to students and families at the start of every term.

Academic Policies & Procedures

St George College Policies and Procedures are available on the website at www.sgc.sa.edu.au, and in the College Student Diary.

Current Address Details

International students MUST maintain a current residential address with St George College AT ALL TIMES. Please email registrar@sgc.sa.edu.au should your address or contact details change. You will be asked to confirm or update your contact details every six (6) months.

International Student Visa Conditions

For a full list of **mandatory** and **discretionary** student visa conditions please visit www.homeaffairs.gov.au



Quick Guide to Key Personnel & Emergency

Head of House and Wellbeing covers the following:

- Questions about content of units, teaching procedures, assessment.
- Questions about the program, academic regulations, difficulties with study, decisions to defer from study
- Help with reading, writing, note taking, preparation for exams & assignments
- Problems with relationships, homesickness, depression, relationship issues.
- Spiritual / religious issues, personal problems.
- Sexual harassment, discrimination issues.
- Examination / study adjustments.

Registrar and Principal covers the following:

- Visa problems, financial problems, enrolment, and HHA accommodation
- Health care/ insurance problems, academic progression, accommodation, understanding of how to utilise institution processes effectively.
- Accommodation issues

Director of Daily Operations

- Timetable, registration in subject units

Receptionist

- Change of address

EMERGENCY 000

or 112 from my mobile (to override key locks)

Government Departments

DHA– Department of Home Affairs

131 881 www.homeaffairs.gov.au

ATO– Australian Taxation Office

Tax File Number:**132 861** www.ato.gov.au

Institution 24hr Emergency

If an International Student is involved in a health or safety emergency, they must ring **000** and ask for Police or Ambulance or Fire attendance to receive immediate assistance.

Once the appropriate authority has arrived and provided the Emergency support requested, please call **Mr Peter Karamoshos, Principal**, on **0400 664 519** to notify him of the emergency so he can offer additional wellbeing support through the structures established at St George College for our International Students.

(If call goes to Message bank, please also text the Principal, Mr Peter Karamoshos, your full Visa name and your mobile immediately).



Campus & Facilities MAP

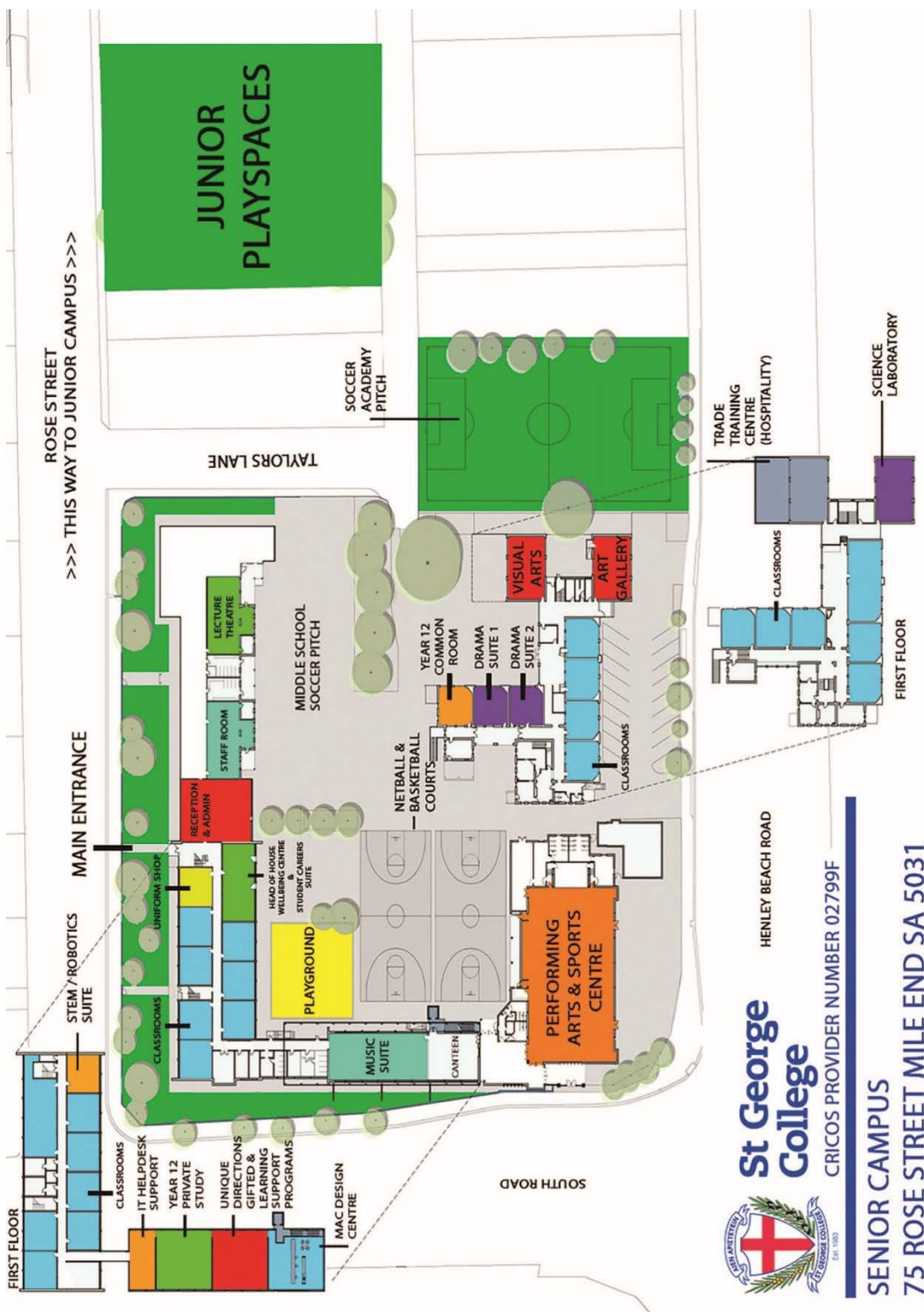

HENLEY BEACH ROAD

St George College

CRICOS PROVIDER NUMBER 02799F

SENIOR CAMPUS

75 ROSE STREET MILE END SA 5031

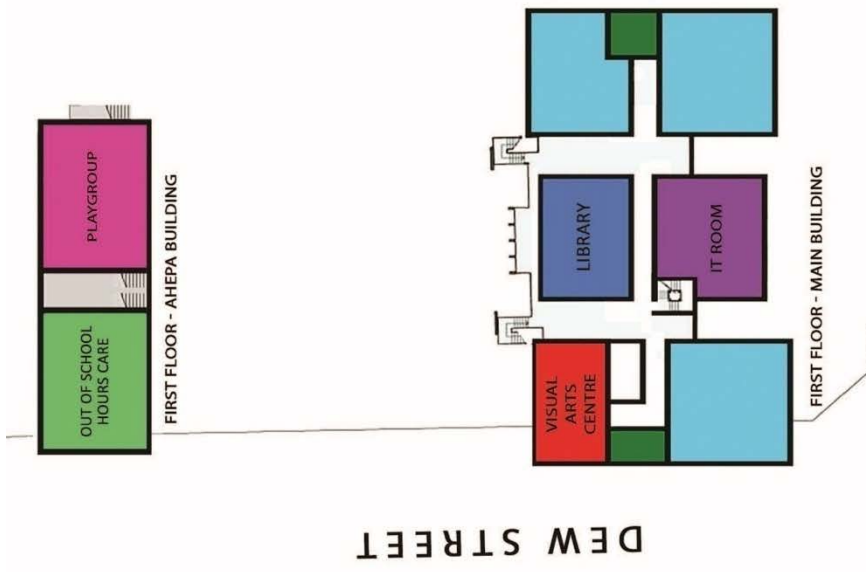
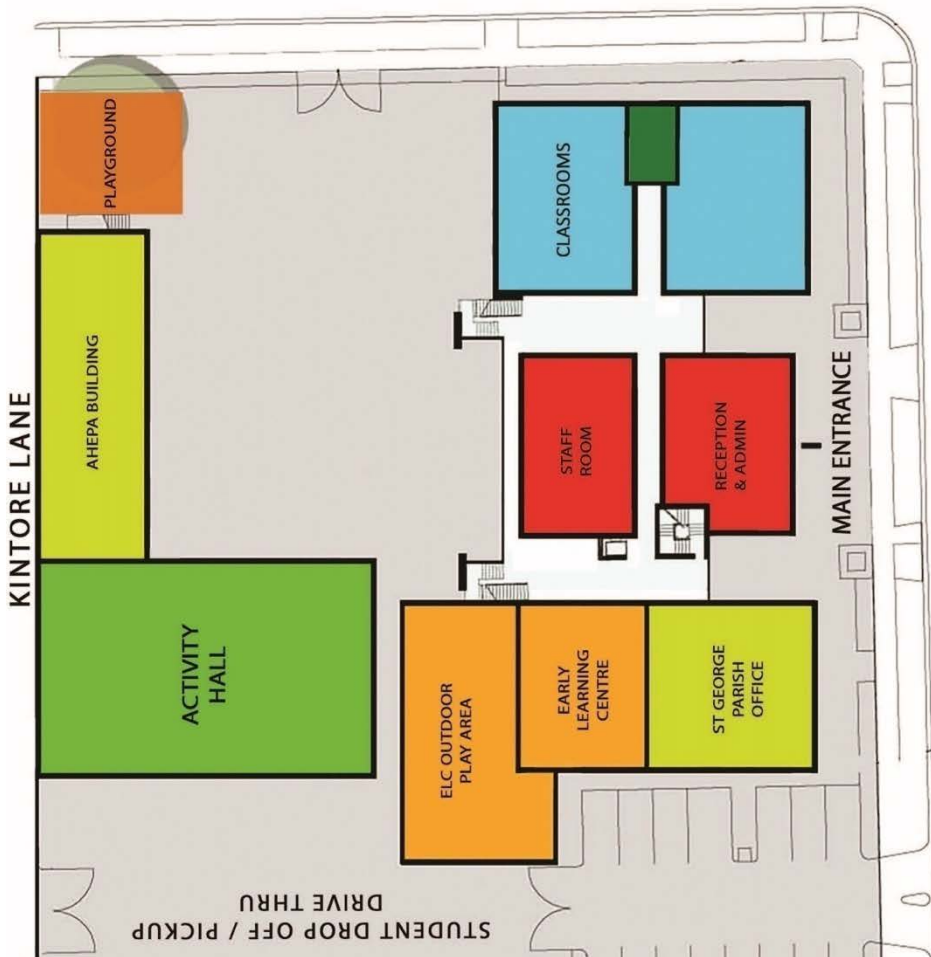

DEW STREET



St George College

CRICOS PROVIDER NUMBER 02799F

JUNIOR CAMPUS
54 ROSE STREET MILE END SA 5031

ROSE STREET
<<<< THIS WAY TO SENIOR CAMPUS <<<<

JUNIOR PLAY SPACES



St George College

sgc.sa.edu.au

Campus Locations

Junior Campus (ELC-4)
54 Rose Street,
Mile End SA 5031
P: 8 8159 8117

Senior Campus (5-12)
75 Rose Street,
Mile End SA 5031
P: 8 8159 8100



Est. 1983

St George College